

ELEIKO VERTICAL PLATE RACK

Art.no. BD-1-527

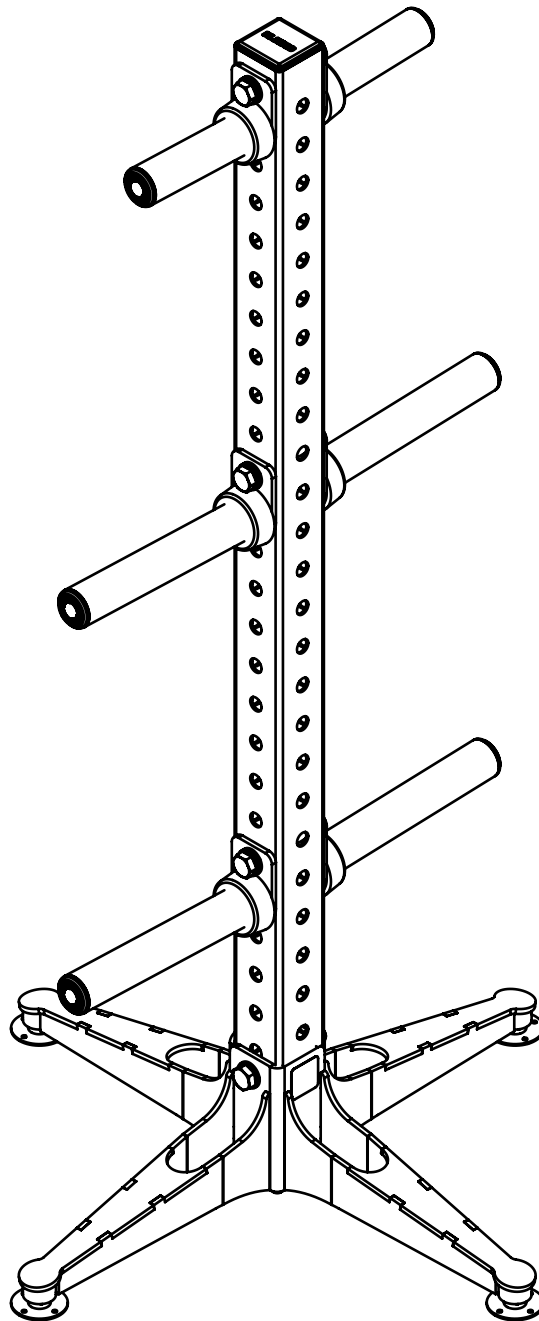

ELEIKO

READ BEFORE INSTALLATION AND USE

Install and use this equipment in a place where access and supervision are specifically controlled by the owner.

Be sure to install the equipment on a stable base and level the equipment properly. Eleiko recommends that all equipment is installed by a licensed contractor or an Eleiko installer.

This equipment is intended for indoor use only.

SAFETY INSTRUCTIONS

It is the responsibility of the purchaser of ELEIKO products to instruct all users and supervising personnel on proper usage of the equipment. It is also the responsibility of the purchaser of ELEIKO products to assess the suitability of the floor, and to choose appropriate fasteners depending on floor type when using ELEIKO products that needs to be bolted to the ground.

1. All included warnings (labels) and instructions **MUST** be read before the use of any Eleiko equipment. Only use the equipment as it is intended.
2. A user **MUST** get a medical examination and proper instructions before using any Eleiko equipment.
3. **DO NOT** let anyone, under any circumstances, use equipment that appears to be damaged. Do not try to repair any equipment before consulting an Eleiko technician.
4. **DO NOT** replace components of Eleiko equipment with other, none Eleiko, equipment (magnetic safety pin, frames, bars etc.). Do not improvise! If there are any doubts, consult an Eleiko representative prior to any intervention.
5. **DO NOT** overload the equipment and **DO NOT** try to exceed personal strength levels.
6. Children under the age of 14 must be supervised by an adult.
7. **DO NOT** remove any safety labels from the Eleiko equipment. Eleiko is not responsible if a label is removed. Replace damaged labels immediately.
8. Eleiko packaging for products can be made of wood. Be aware of splinters! You **MUST** use protective gloves and proper work wear.
9. Eleiko packaging material could be a risk when handling. Be aware of crushing! You **MUST** use work wear including protective gloves and hard shoes.
10. Eleiko products and packing material are heavy, You **MUST** use proper lifting techniques, work wear and hard shoes.

LIST OF COMPONENTS

1x

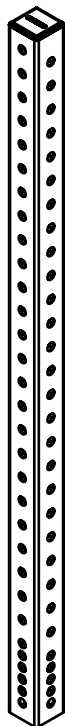

2001791

2x

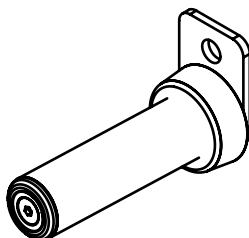

2002175

4x

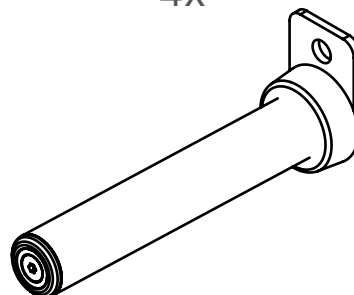

2002176

2x

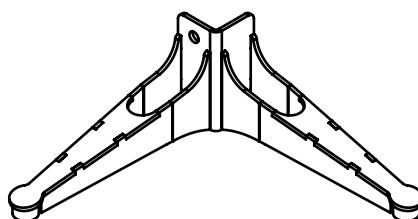

2002169a1

4x

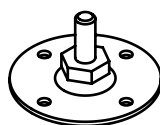

2002018

1x

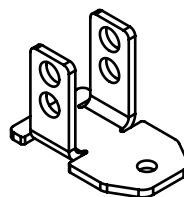

2001373

3x

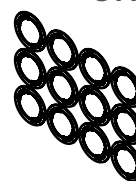

2002140-S1

5x

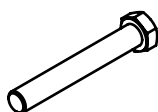

Long screw
2001385-L110

6x



Short screw
2001385-L100

16x



2001421

6x

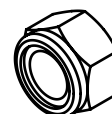

2001379

COMPONENTS TO REMOVE

6x

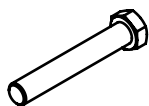

Short screw
2001385-L100

3x



2001421

ASSEMBLY INSTRUCTIONS

Before assembly, make sure you have enough clearance on all sides of the equipment. Take in account the accessibility to remove and replace weights.

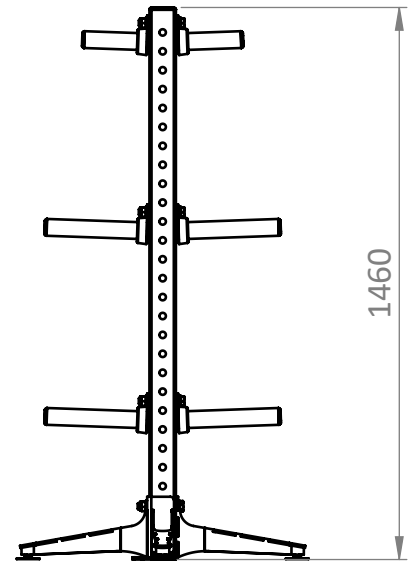
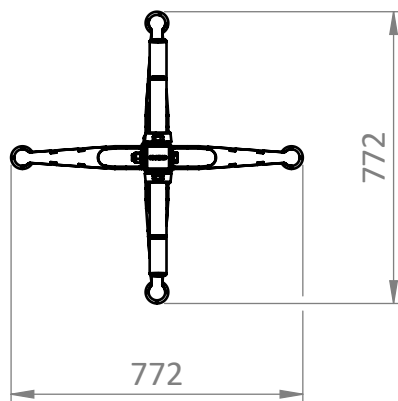

TOOLS NEEDED

You need the following tools to assemble the equipment.

2x



spanner
size 24



spanner
size 13

NOTE: Do not use electric power tools for assembly.

1.

4x

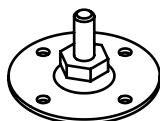

2x

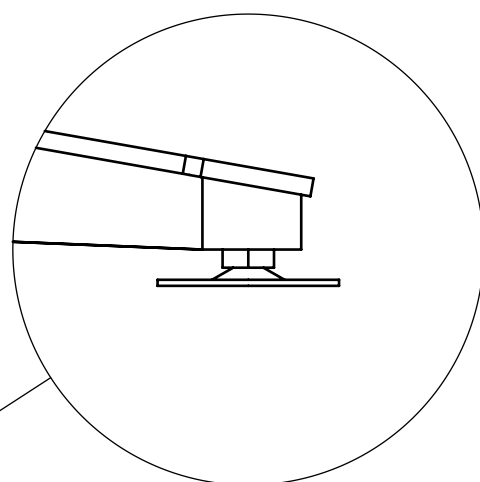
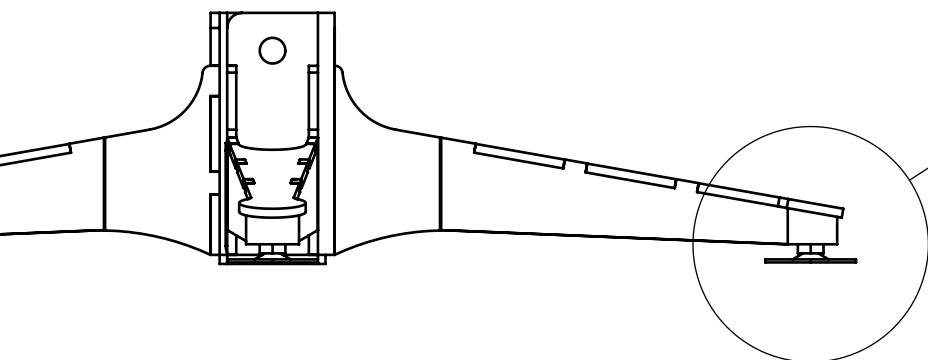
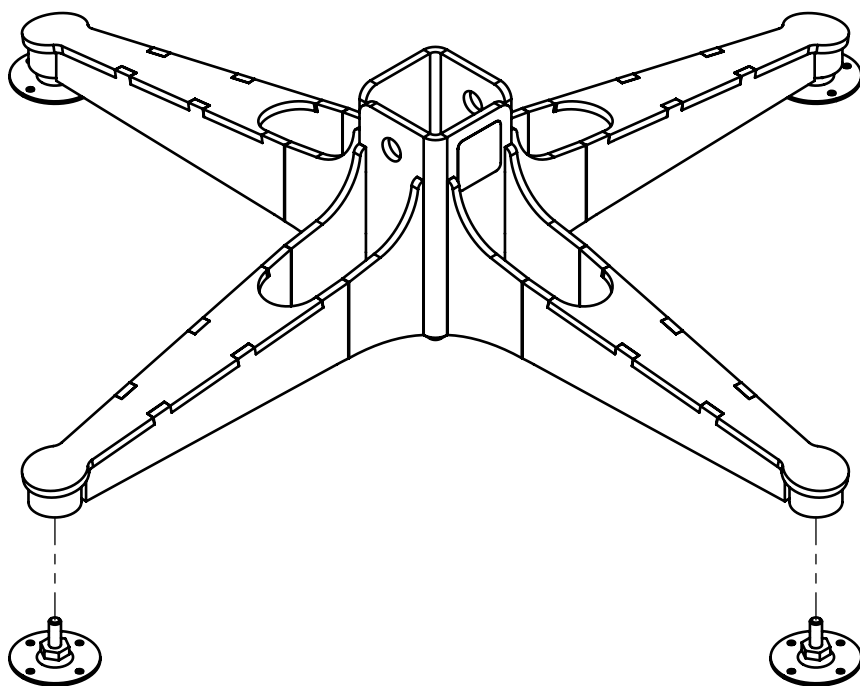
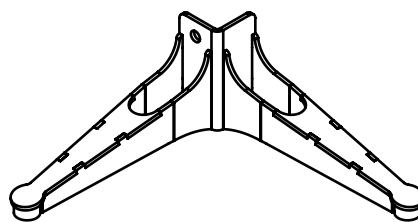

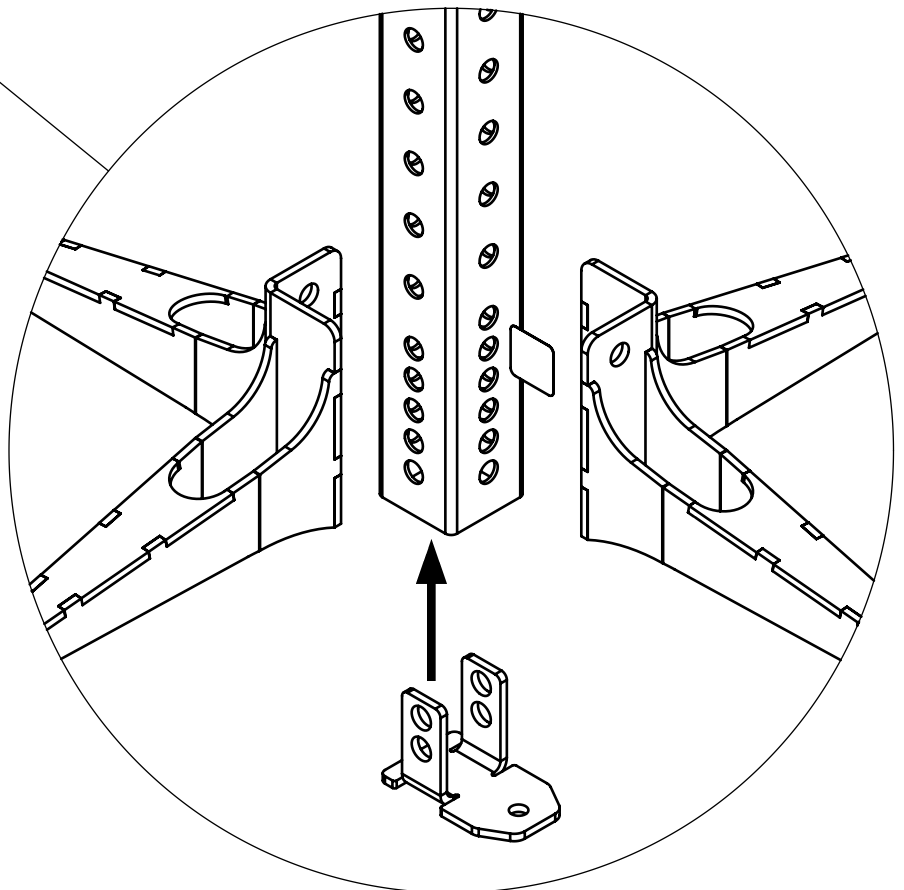
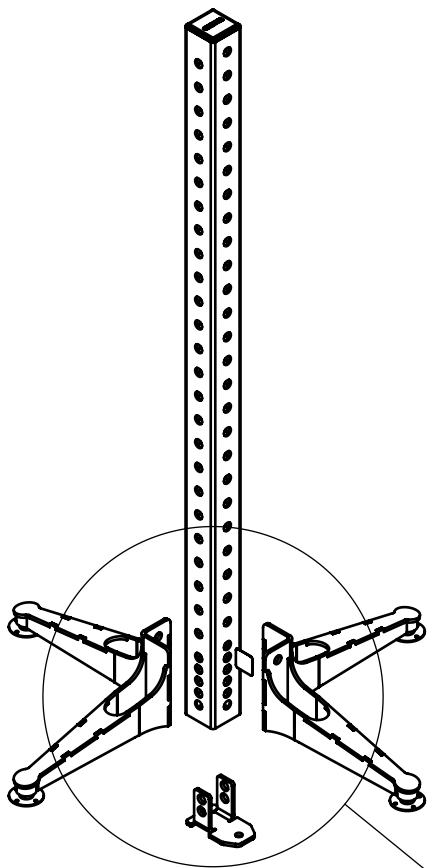
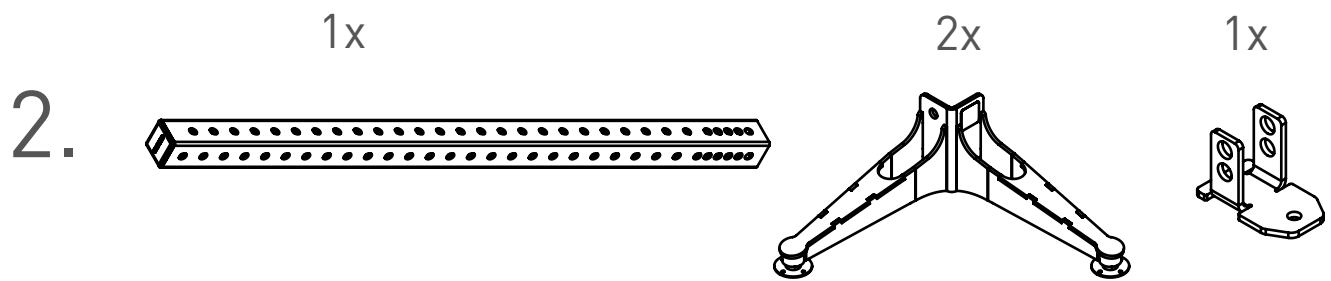

3.

2x

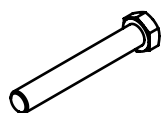

Long screw
2001385-L110

4x



2x

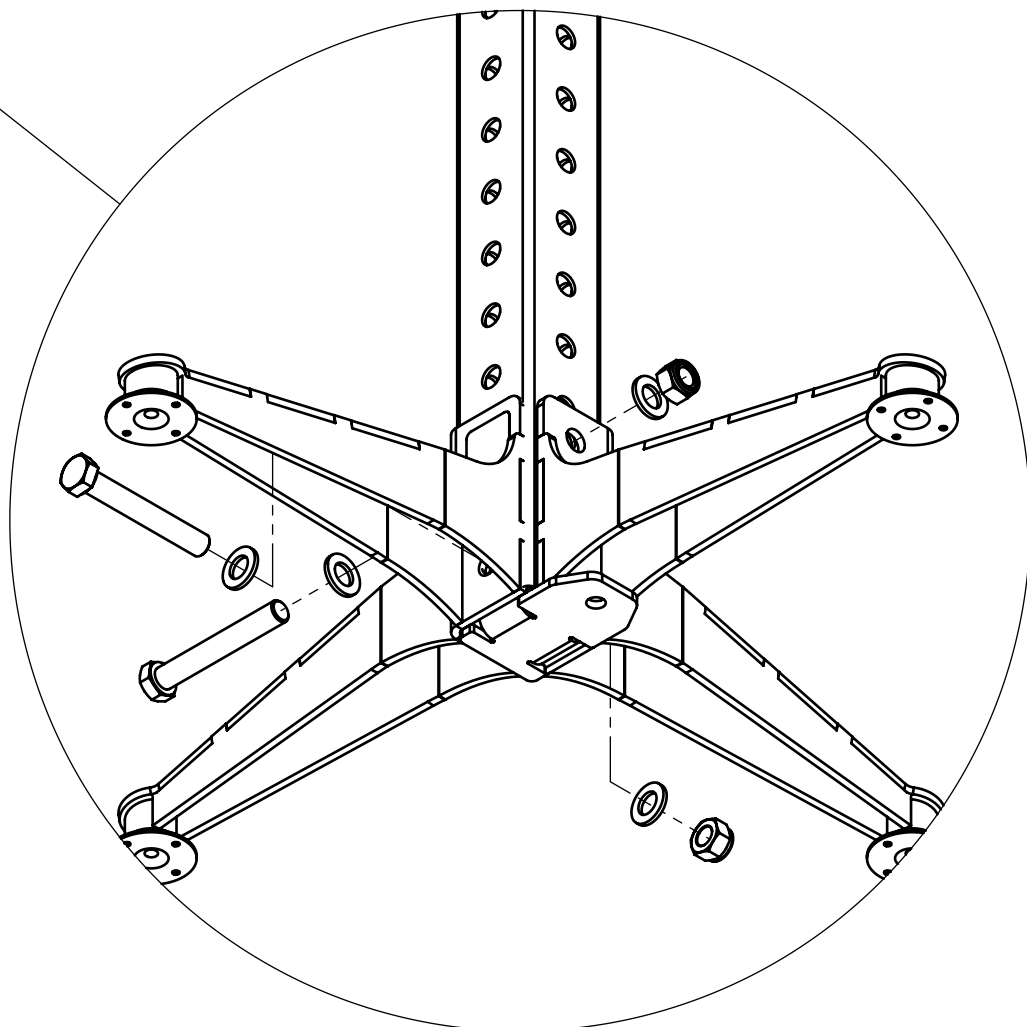
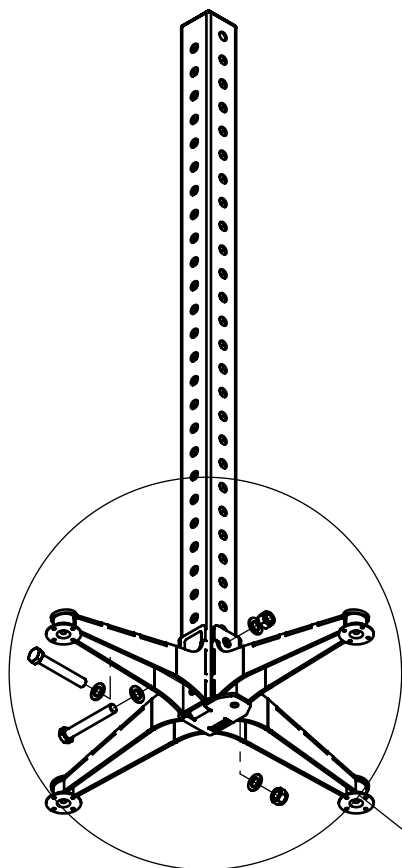
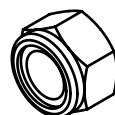

4.

3x

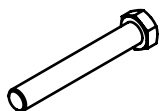

Long screw
2001385-L110

9x



3x

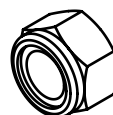

NOTE!

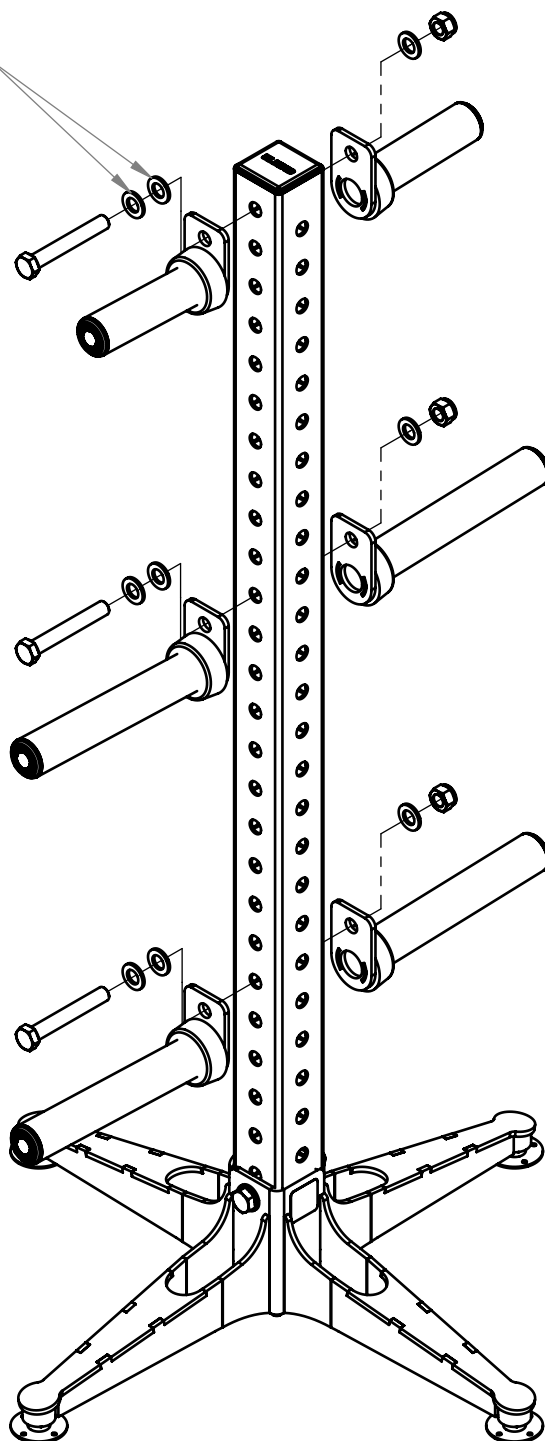

NOTE! This storage rack is not suitable for weight pin L 2002177.

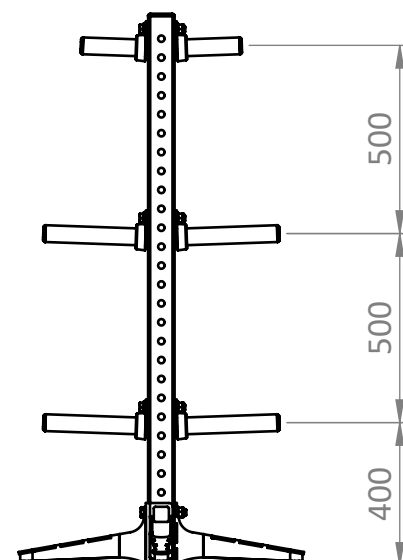

5. 1: Load with equipment.
2: Adjust feet to make weight tree stable.
-

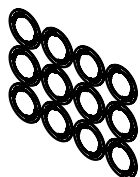

Chose color from sheet of decals,
to match color of plates.

Clean this surface
before adding decal.

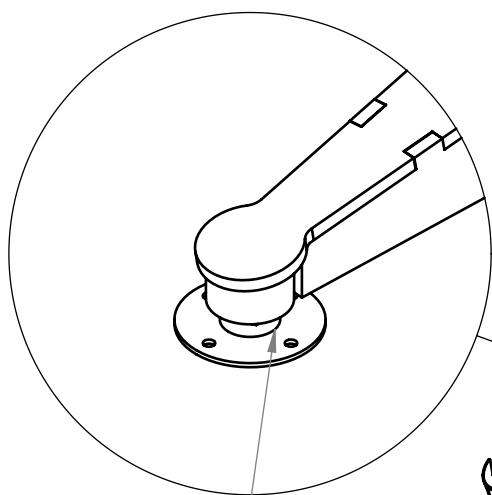
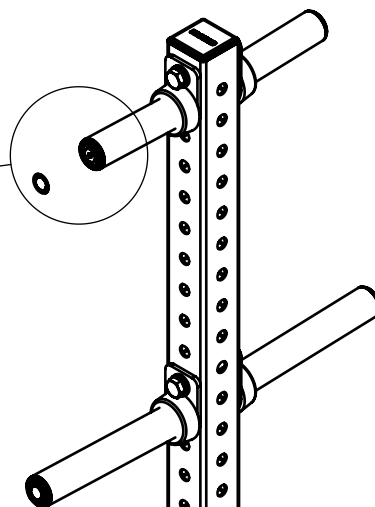
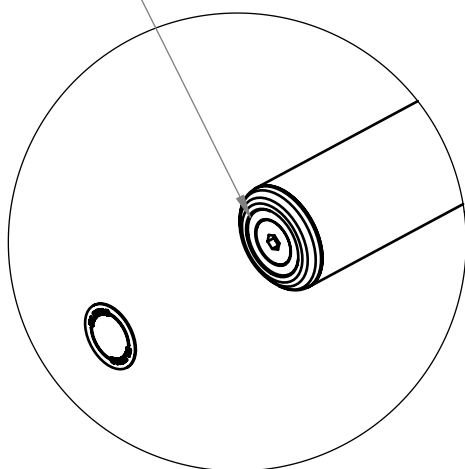

spanner
size 13

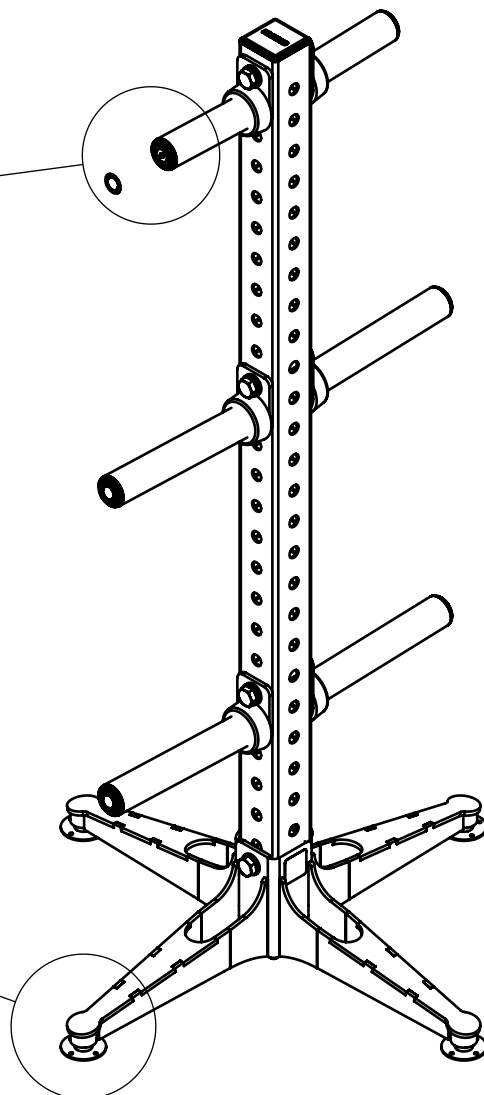

Adjust with spanner to make
the weight tree stable.

USER GUIDE

PURPOSE

Vertical storage rack for weight plates, with hole diameter of minimum 46 mm.

GENERAL INSTRUCTIONS FOR USE

Place your weight plates on the storage rack, heaviest plates at the bottom.

NOTE! This storage rack is not suitable for Weight pin large 2002177.

PRODUCT SPECIFICATION

Max weight	500 kg / 1102 lbs
Product weight	25,5 kg / 56 lbs
Dimensions (L x W x H)	772 x 772 x 1460 mm 30.4 x 30.4 x 57.5"

CARE AND MAINTENANCE

PREVENTIVE MAINTENANCE AND INSPECTIONS

NOTE: The safety level of the equipment can only be maintained if it is examined regularly for damage and wear.

Regularly:

- Clean surfaces on the frames and tubes from dust and dirt.
- Check that all bolts between parts are properly tightened, according to recommendations.
- Check equipment for sharp edges. Replace parts with sharp edges.

See also www.eleiko.com.

SPARE PARTS AND SERVICE

Contact Eleiko for spare parts and service:

Eleiko Group AB | Klastorpsvägen 18 | SE-302 62 HALMSTAD | Sweden
E-mail: info@eleiko.com | Phone: +46 35 17 70 70
www.eleiko.com

WARRANTY

All products manufactured by ELEIKO are warranted to the original purchaser to be free from defects in workmanship and / or materials under normal use or service as follows:

- 10 years on structural frame welds (NOT on moving parts)
- 1 year on wear and tear parts

Normal wear and tear do not fall under the warranty.

ELEIKO

Eleiko Group AB | Klastorpsvägen 18 | SE-302 62 HALMSTAD | Sweden
E-mail: info@eleiko.com | Phone: +46 35 17 70 70

www.eleiko.com