

ELEIKO PRESTERA BAR RACK

Art.no. 2001995

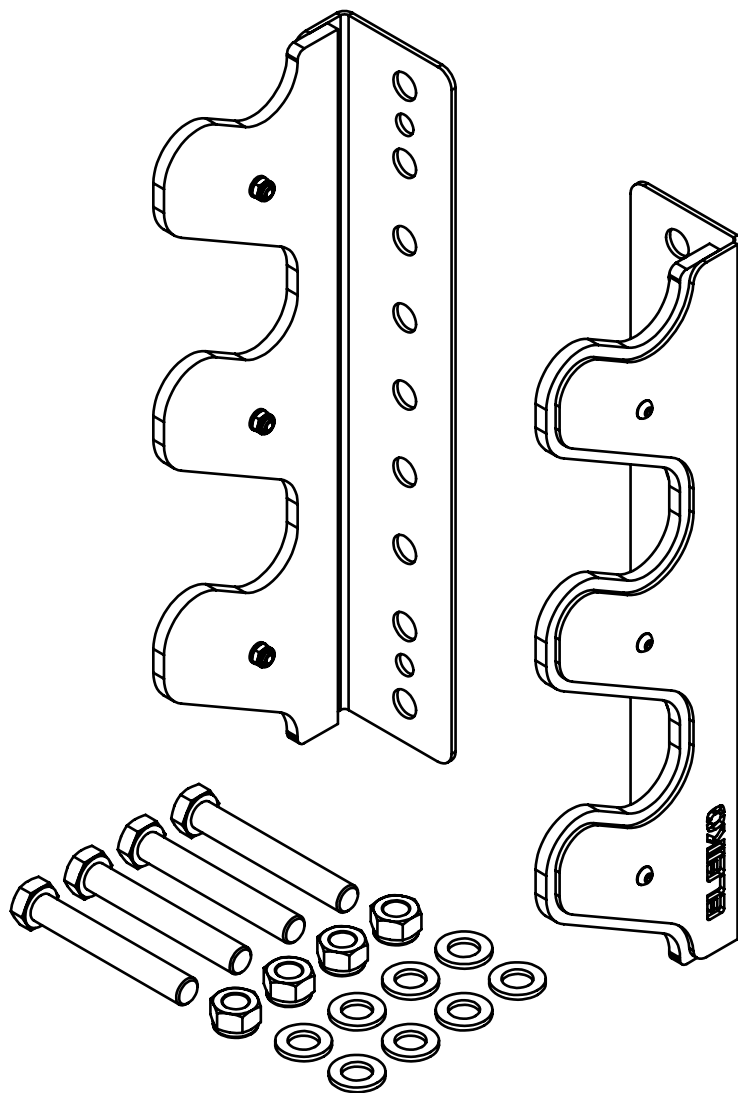

ELEIKO

READ BEFORE INSTALLATION AND USE



Install and use this equipment in a place where access and supervision are specifically controlled by the owner. Only to be mounted on recommended Eleiko products. Consult Eleiko sales for recommendations.

SAFETY INSTRUCTIONS

It is the responsibility of the purchaser of ELEIKO products to instruct all users and supervising personnel on proper usage of the equipment.

1. All included warnings (labels) and instructions **MUST** be read before the use of any Eleiko equipment. Only use the equipment as it is intended.
2. A user **MUST** get a medical examination and proper instructions before using any Eleiko equipment.
3. **DO NOT** let anyone, under any circumstances, use equipment that appears to be damaged. Do not try to repair any equipment before consulting an Eleiko technician.
4. **DO NOT** replace components of Eleiko equipment with other, none Eleiko, equipment (magnetic safety pin, frames, bars etc.). Do not improvise! If there are any doubts, consult an Eleiko representative prior to any intervention.
5. **DO NOT** overload the equipment and **DO NOT** try to exceed personal strength levels.
6. Children under the age of 14 must be supervised by an adult.
7. **DO NOT** remove any safety labels from the Eleiko equipment. Eleiko is not responsible if a label is removed. Replace damaged labels immediately.
8. Eleiko packaging for products can be made of wood. Be aware of splinters! You **MUST** use protective gloves and proper work wear.
9. Eleiko packaging material could be a risk when handling. Be aware of crushing! You **MUST** use work wear including protective gloves and hard shoes.

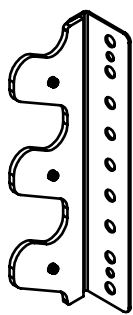
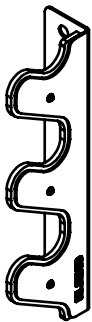
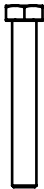
LIST OF COMPONENTS

1x	1x			
				
2001995a2	2001995a1	2001385-L110	2001379	2001421

TOOLS NEEDED

You need the following tools to assemble the equipment.

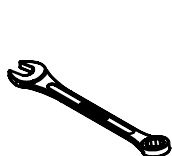

wrench 24mm



socket wrench
24 mm



30 Nm



ASSEMBLY INSTRUCTIONS

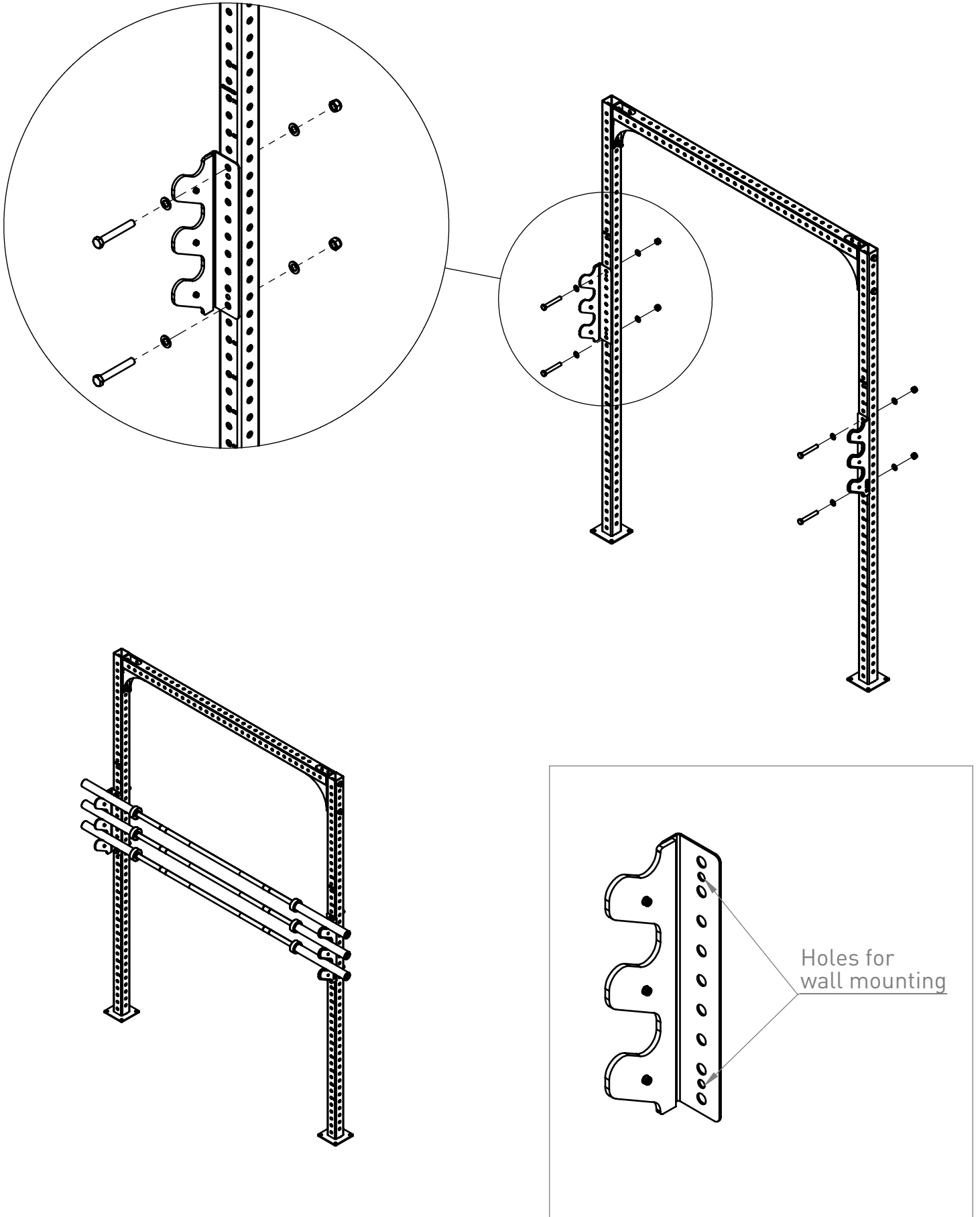

USER GUIDE

PURPOSE

A storage rack that can store three barbells. It can be mounted in a rig, in a rack and directly to the wall.

GENERAL INSTRUCTIONS FOR USE

1. The rack can be mounted in both 1072 mm and 1720 mm sections of a rig or rack.
2. When mounted to a rack or a rig, use the M16 bolts, washers and nuts that comes with the product.
3. When mounting to a wall, consult a licensed contractor to choose the appropriate anchoring bolts since they are not included. Ensure that wall can withstand the forces generated.
4. When mounting to a wall, mount the brackets wide enough so that the barbell sleeves lies against the plastic protection.

PRODUCT SPECIFICATION

Max weight	60 kg / 135 lbs
Product weight	5 kg / 11 lbs
Dimensions (L x W x H)	146 x 83 x 450 mm 5,7 x 3,3 x 17,7"

CARE AND MAINTENANCE

PREVENTIVE MAINTENANCE AND INSPECTIONS

NOTE: The safety level of the equipment can only be maintained if it is examined regularly for damage and wear.

Regularly:

- Clean surfaces on the frames and tubes from dust and dirt.
- Check that all bolts between parts, walls and floors are properly tightened, according to recommendations.
- Check equipment for sharp edges. Replace parts with sharp edges.

See also www.eleiko.com.

SPARE PARTS AND SERVICE

Contact Eleiko for spare parts and service:

Eleiko Group AB | Klastorpsvägen 18 | SE-302 62 HALMSTAD | Sweden

E-mail: info@eleiko.com | Phone: +46 35 17 70 70

WARRANTY

All products manufactured by ELEIKO are warranted to the original purchaser to be free from defects in workmanship and / or materials under normal use or service as follows:

- 10 years on structural frame welds (NOT on moving parts)
- 1 year on wear and tear parts

Normal wear and tear do not fall under the warranty.